

SAE MILWAUKEE

An SAE International Section

Upcoming Events

MacLean-Fogg,
Whitewater Plant

- October 12th

Student Night, Marquette
University

- November

September 2015 Newsletter

October Event:



MACLEAN-FOGG

October 12th, 2015

5:00PM

420 N Universal Blvd,
Whitewater, WI



MACLEAN-FOGG

Celebrating 90 years of private enterprise



Founded in 1925, MacLean-Fogg is a global enterprise with 32 global manufacturing facilities, annual sales of about \$ 1 billion, and a worldwide workforce of more than 3,000 people. MacLean-Fogg is privately held company headquartered in Mundelein, IL.

MacLean-Fogg is comprised of two primary businesses, Component Solutions and Power Systems.

Power Systems (MPS) is a leading manufacturer of products for the electric utility, telecommunications and civil markets.



Component Solutions (MFCS) is a leading manufacturer of fastener components, engineered components and linkage suspension components for automotive, heavy truck, aerospace and other diverse industries. Core MFCS products include locknuts, decorative automotive wheel fasteners, high temperature fasteners, forgings, cold formed products, machined products and functional engineered plastic components.



Engineered Plastics Company (EPC) is a division of MFCS. Core competency includes Close Tolerance Engineered Functional molding, including regular and two-shot insert molding. EPC works with customers to optimize components to reduce cost, reduce weight and maximize customer value.

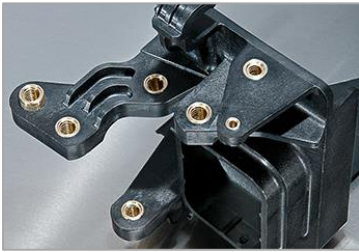
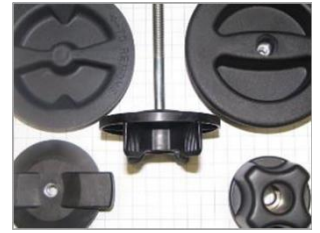

EPC has two locations, one in Whitewater and one in Menomonee Falls. Key customers include: Ford, GM, Harley-Davidson, Johnson Controls, Pentair and others. Key products include: hood levelers, spare tire tie-downs, insert molded retainer nuts, battery covers, electronic/battery caddies, air duct assemblies, suspension assemblies, over-molded components, valve bodies, and many others.

About the Presenters

Rob Whitney



Rob Whitney is the President of MacLean-Fogg Component Solutions Engineered Plastics organization including two manufacturing facilities in Wisconsin and one in Germany. He joined MacLean-Fogg in 2000 and has held various technical and General Management positions at several of the MFCS divisions including Metform, Flowform, Dynalink (Europe & North America).

Prior to joining MacLean-Fogg, Rob was employed at Ford/Visteon and was involved in chassis and driveline engineering and sales.

Rob is a licensed Professional Engineer, and holds a Bachelor of Science and Master of Science degree in General Engineering from the University of Illinois. Additionally, Rob holds an MBA from the University of Illinois.

Randy Race



Randy Race is the Director of Engineering for EPC. He holds a BS in Mechanical Engineering from Lake Superior State University. Randy has worked at MacLean-Fogg for 13 years, working in Applications, Sales, and as the Director of Engineering.

Prior to working at MacLean-Fogg, Randy worked at Delco Electronics as a controls engineer, and TRW Steering and Suspension as a systems engineer.

Dave Davis



Dave Davis is the Sales and Marketing Manager for EPC. He has 35 years of experience in the plastics industry in areas of application development, materials, business development, business management, sales & marketing, advanced technologies, business strategies and intellectual property development & management.

Prior to joining MacLean-Fogg, Dave had worked at several other companies in the plastics industry, including Toyoda Gosei as General Manager – Sales Planning, Guardian Industries as Business Unit Director, and Venture Industries as Vice President – Business Development.

Dave holds a Master's Degree in Business Management from Central Michigan University, and BS in Business/Marketing with Plastics Technology from Ferris State University.

Event Agenda

Event Agenda

Registration	5:00-5:30pm
Tour.....	5:00-6:00pm
Dinner.....	6:00-6:30pm
Presentation.....	6:30pm-8:00pm

Registration Fees

SAE Members	\$20.00
Retirees.....	\$15.00
Guests/Non-members	\$30.00
Students.....	\$5.00

Registration

Registration Deadline: October 5th

Maximum Attendance: 70 attendees

Ways to Register:

- Online with a charge card via www.milwaukeeesae.com
- By phone: (920) 988-5542 (Karl Hundt)
- By email: hundtk@msoe.edu (Karl Hundt)

Registration required – no walk-ins allowed

Plant Tour: Some highlights of the equipment that will be seen on the tour include insert molding, automated robotic assembly, ultrasonic welding, and automated molding.

Dinner Menu:

- Chicken breast
- Sliced roast beef
- Mashed potatoes and gravy
- Corn
- Dinner rolls
- Fruit salad
- Pie

Event Location

420 N Universal Blvd, Whitewater, WI 53190

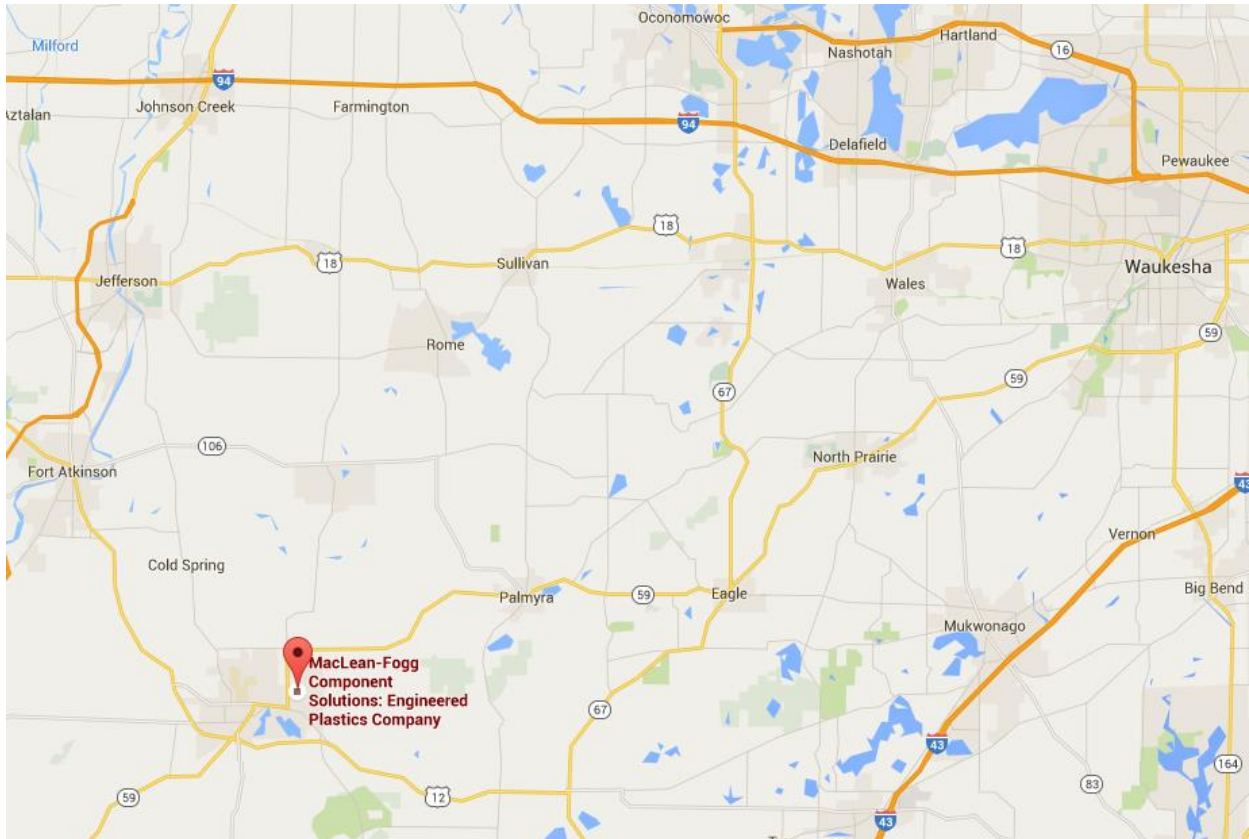

Thank you to Wacker Neuson

We would like to say a special thanks to Wacker Neuson for donating funds to cover the meal at the September event, which they graciously hosted at their facilities. In doing so, they are helping to fund SAE student projects through the addition of money to our Student Night Prize Fund. Prizes will be awarded to students at the November SAE Event.

SAE Milwaukee Board Member Spotlight



Garrett Herning – Chairman

Greetings! I am sure most of you have seen me introduce our speakers at our event over the last three years. In this spotlight I hope to give you a better introduction and why I am involved in the Milwaukee SAE section. Please don't hesitate to come and talk with me at one of our events.

I am a Wisconsin native. I was born in Waukesha and grew up a short 30 minutes north of Green Bay in Oconto Falls. Growing up I was always building things. My idea of playing involved constructing buildings and cars out of cardboard, balsa wood, and popsicle sticks. The older I got, the more intricate the designs as simple cars began to include working suspensions, opening doors and trunks, and finally wires and lights. It was never really a question of what I was going to do when I grew up, but rather what kind of engineering.

I attended the University of Wisconsin –Platteville in 1994 to pursue a mechanical engineering degree. After a year, I decided that an electrical engineering degree would also be useful, so I pursued both degrees simultaneously and graduated with Bachelor's of Science degrees in both. I have often hoped that would lead to two paychecks. I am, however, still waiting for that to pan out.

After college I moved out to southern New Jersey and worked at a small company called Zoom Technology that designed and developed test equipment for the automotive automatic transmission rebuilding and testing industry. We worked mainly with Mom and Pop shops, but we did have several projects for major automakers. In 2008 I relocated back to the Midwest, taking a job at Power Test in Sussex, WI. I am currently a Project Engineer and work on the design of hydraulic and transmission testing equipment for the on and off highway industry. Many of these customers are either dealerships or OEM rebuilders.

After relocating back to WI, I was pleased to find that Milwaukee had an active and healthy SAE Section. In 2012 I volunteered to help out and was warmly welcomed to join the board as Vice-Chairman. Volunteering on the board has been a very rewarding experience. We have a dedicated group of people who work hard to make our section one of the top SAE sections in the country. There is a lot of great engineering and manufacturing right in the Milwaukee area and it is a real treat to be part of the process of showcasing that through our events and tours to our engineering community.

Milwaukee Section 2015-2016 Governing Board

CHAIRMAN:

Garrett Herning—Power Test Dynamometers
garretth@pwrst.com

VICE CHAIRMAN:

Van Phifer

SECRETARY AND BAJA CHAIRMAN:

Drew Caron—Rexnord
andrew.caron@rexnord.com

TREASURER:

Mitch Crawford—Modine Manufacturing Co.
m.s.crawford@na.modine.com

HISTORIAN & COMPANY**AMBASSADOR:**

Wayne Richter
richterway@sbcglobal.net

AWIM/EDUCATION:

Sid Jain - Modine Manufacturing Co.
S.Jain@na.modine.com

WEBMASTER:

Cara Kazda—Cummins Filtration
cara.kazda@cummins.com

MEMBERSHIP VICE CHAIR:

Nerissa Hanson—Harley-Davidson
nerissa.hanson@harley-davidson.com

COLLEGIATE RELATIONS:

Mike Krauski—UW-Milwaukee
krauski@uwm.edu

STUDENT ACTIVITIES:

Randy Hoffman—WCTC
rhoffman2@wctc.edu

CAREER DEVELOPMENT:

Dale Wiza—Professional Engineering Placements
dale@engineeringplacements.com

SENIOR ADVISOR:

Kurt Person—Hayes Performance Systems
kurt.person@hbpsi.com

SOCIAL MEDIA MANAGER:

Drew Boyer—Modine Manufacturing Co.
a.m.boyer@na.modine.com

NEWSLETTER EDITOR:

Mike Fricke—HUSCO Automotive
michael.fricke@huscoauto.com

A Letter from the Chairman

Hello SAE Milwaukee Section Members and Friends,

The kids have returned to school and we can see the leaves are beginning to show a color here and there, signaling that fall is here. I hope your Labor Day weekend was enjoyable.

We started off the SAE year with our first event at Wacker-Neuson. They showed us the utmost hospitality and did not disappoint on the tour, dinner, and presentation. If you missed it, you missed out. They also sponsored the meal for the evening, so I'd like to recognize them as this not only helps strengthen our section, but our student sections as well.

This month we will be at MacLean-Fogg. Maclean-Fogg has been very involved in SAE being a large sponsor of the Clean Snow Challenge. This month they are going to take us into their manufacturing facility and let us participate in the innovation process they use from a concept a customer bring them, to a finished product that they deliver. This is going to be an exciting exercise for student and veteran engineers alike, so be sure to keep this on your calendars.

In November we will have our annual Student Night, where we showcase the student vehicles and let them compete for the sponsorship money we have allocated for them. Last year we had 5 schools and over 70 students in attendance. They did an incredible job and we expect a repeat performance this year. If you have never been to a student night, it's not just for students. This is a wonderful networking event as well as a way to give guidance and feedback to some up and coming engineers who will be joining us in industry in the next few years.

As a section we have several initiatives we are working on this year. Some of these are engaging middle school and high school kids to a career in engineering, engaging our members through events and tours, and supporting the six engineering colleges in our area in the SAE Colligate Design series. In order to accomplish these things, we are always looking for volunteers. If you are interested in a board position or just to help out with a meeting or two, please talk to any of the current board members about the spot we have for YOU!

I look forward to seeing you at an upcoming event.

Garrett Herning

SAE Milwaukee Section - Chairman

SAE Board Member Shadow Program

Members, your board of directors has created a new way for you to get involved in the activities of the SAE Milwaukee Section!

Do you like the service and support that your SAE Milwaukee Section provides to you? Do you have some fresh ideas to make your section better? Or.....would you like to just get involved?

If you would like to participate but do not know how to get started, we have the program for you. This new program allows you to shadow a board member to learn the details of what they do for this section. With this opportunity you can investigate/help a position that interests you without jumping in with both feet. This will allow you to participate to the level you are comfortable with or find the position that suits your talents and/or interests.

We would like to invite you to Shadow a Board Member.

If you are interested in this opportunity please contact Randy Hoffman at (920) 397-6644.



SAE Milwaukee STEM/AWIM program

Your Milwaukee Section needs your help with expanding the AWIM program within the local schools. AWIM (A World In Motion) is a teacher-administered, volunteer-assisted program that brings Science, Technology, Engineering and Math (STEM) education to life for K-12 grade students. Program focuses on various age-appropriate challenges that are taught through the use of “kits” – students build different models using these kits while learning about basic principles of physics, motion and flight.

We have paired up with Messmer Prep and St. Rose/St. Leo schools in Milwaukee and will be introducing the AWIM program there



- Both schools are part of the Messmer Catholic Schools and serve the inner city students through a Voucher/Choice program
- This is **first time** a program of this kind is being introduced at Messmer – the program was **specifically requested by teachers** there to inspire girl students and encourage them to pursue STEM subjects later in their educational career
- AWIM program to be introduced for 4th and 5th grade students at both schools, with a focus on all 3 elementary and one middle school challenge
- **We want YOUR help** in assisting students in Fall and Spring sessions in after-school program setting (~ 3:30 – 5:00 pm)
- **For more information on volunteering, please contact Sid Jain, S.Jain@na.modine.com**

Section Sponsors

Newsletter communications brought to you by...

Ken Cook Co.

Innovation in Technical Communication

Ken Cook Co.'s mission is to support client customers by developing and distributing client product operating, service and parts information worldwide. Ken Cook is known worldwide for the production of quality technical support documentation in electronic and printed formats and in most languages. Web design, ISP hosting, e-learning, e-business and internet communications are available to our customers.